

## Korpi 14 and 18



<sup>®</sup>  
Tulikivi

# Ready made installation package

- Wools
  - 4 mm, core insulation&protection
    - 55 cm wide wool, XX meters
    - 12 cm wide wool, XX meters
    - 2 pcs precutted 3 mm ceramic paper
  - 10 mm, Chimney connection insulation
    - 20 cm, XX m
- Door unit
- Firebox panels
- Chimney pipe
- Support metal
- Accessories
  - Clips and metal stripes
  - Silicone, soudal HT
  - Thin metal stripes for installation
    - 8 x 60 cm?



# Pievu installation



Precut hole surface direction

- Glue on corners of the first bottom layer
- Install surface stones
  - From top with clips



# PIEVU installation



Precut hole from surface direction

Cut the hole open IF:

- Inside air
- Outside from back side



# Pievu installation



- Install tape or tightening belt in the bottom miter corners
- Check cross dimension



# Pievu installation



- Put HT silicone to miter corners from inside -> air tight core



- Also in the bottom line



# Pievu installation

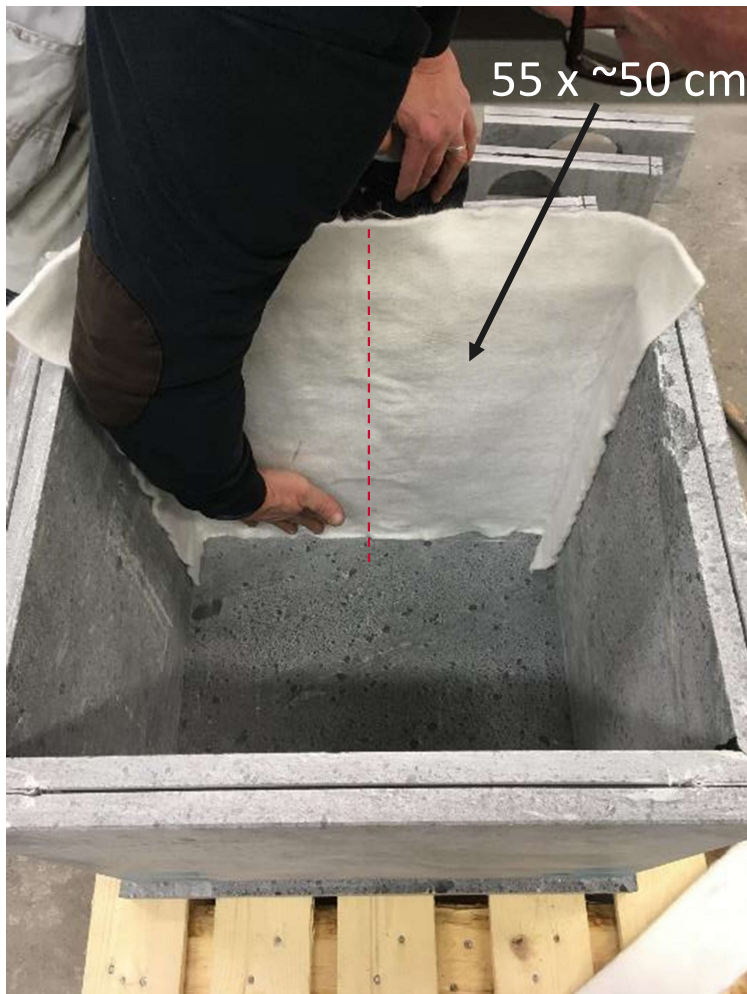

Tap the hole to the wool



Cut the wool, in burning air from back side



# Pievu installation



Put silicone dots for wool

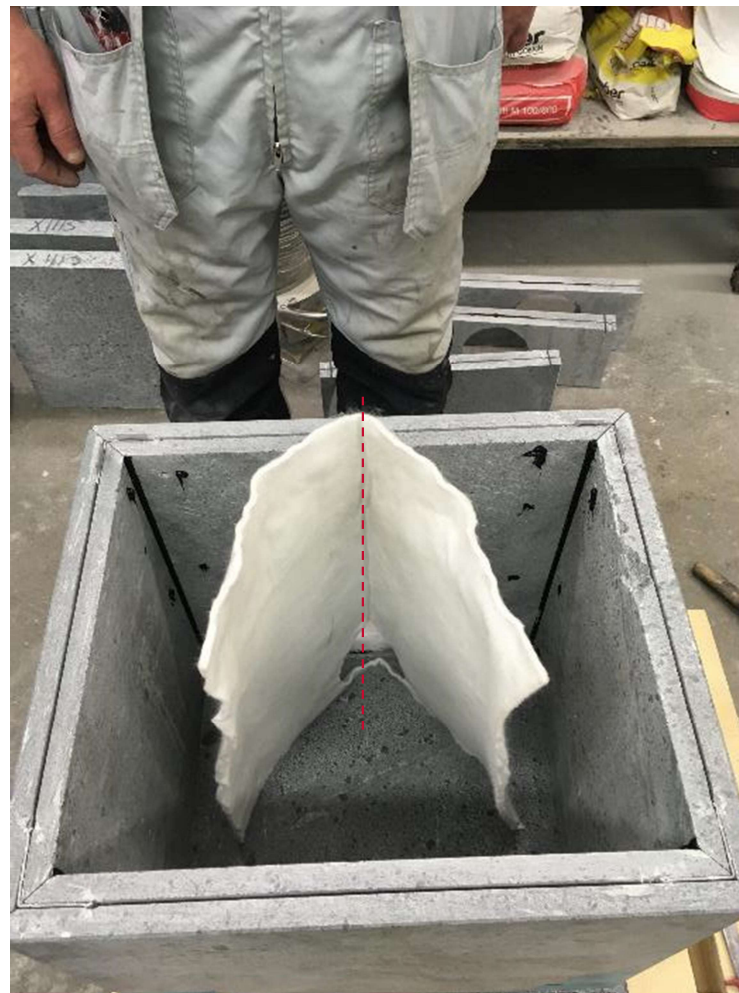

Start putting the wool from the middle





# Pievu installation

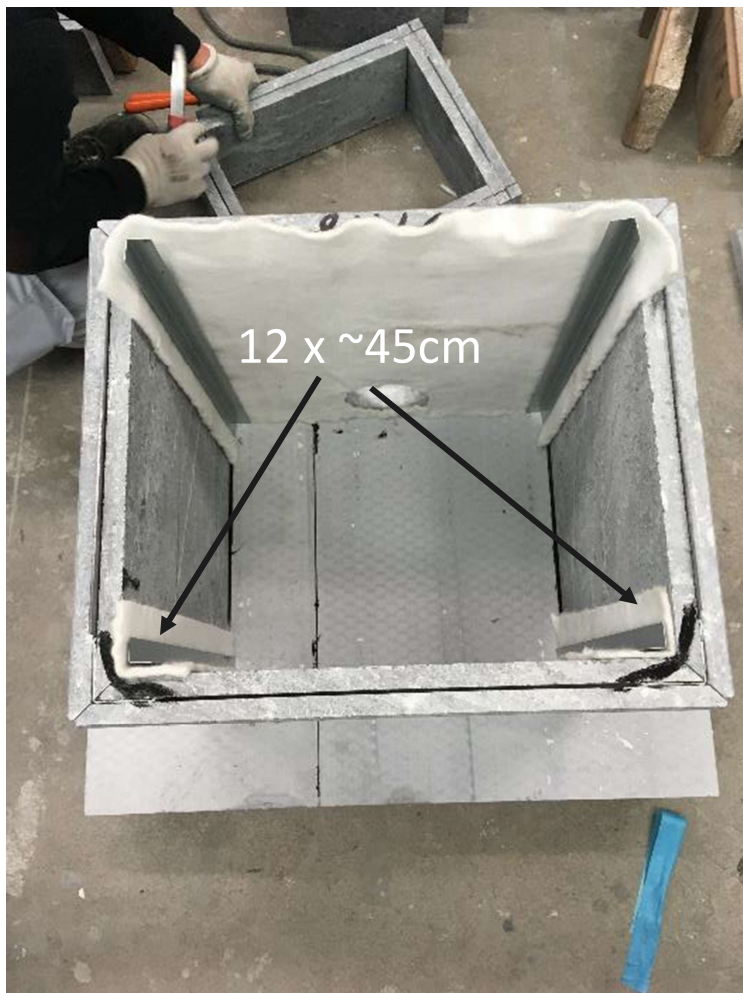

Press wools tightly against the stone with metal stripes



Put the side stone -> use metal stripes



# Pievu installation



Siccors are good tool for cutting wool



Tighten the air hole with silicone and inner corners



# Pievu installation



Silicone to inner stone top



Ceramic paper



# Pievu installation



Drop airbox like in picture



# Pievu installation



Drop against the ceramic paper



Drop door unit to the core



# Pievu installation



Tigh with wools and put ceramic paper in bottom



Insulate gaps besides the door unit



# Pievu installation



Use silicone taps for 30 mm stones



Install metals stripes to clip groove



# Pievu installation



Use silicone dots for 30 mm stones



Use silicone for woools around door and install side stones





# Pievu installation

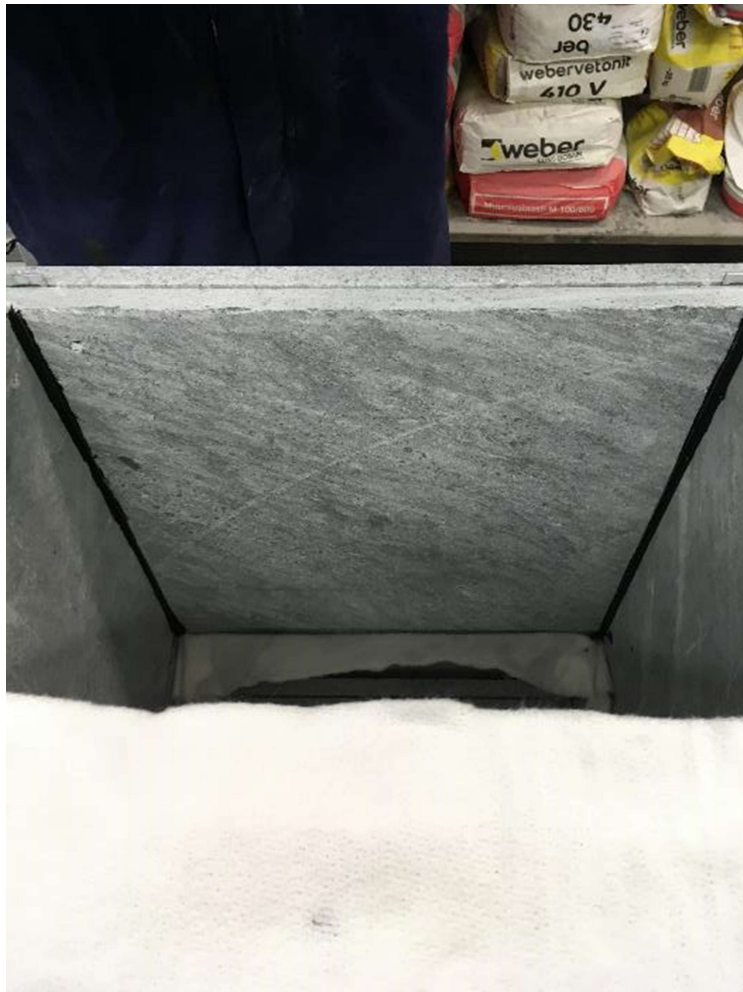

Put silicone to corners



But silicone dots for wools



# Pievu installation



Put silicone to corners  
Wools: 55 x ~35 cm



Install the inside stone plate,  
use tools to have it straight



# Pievu installation

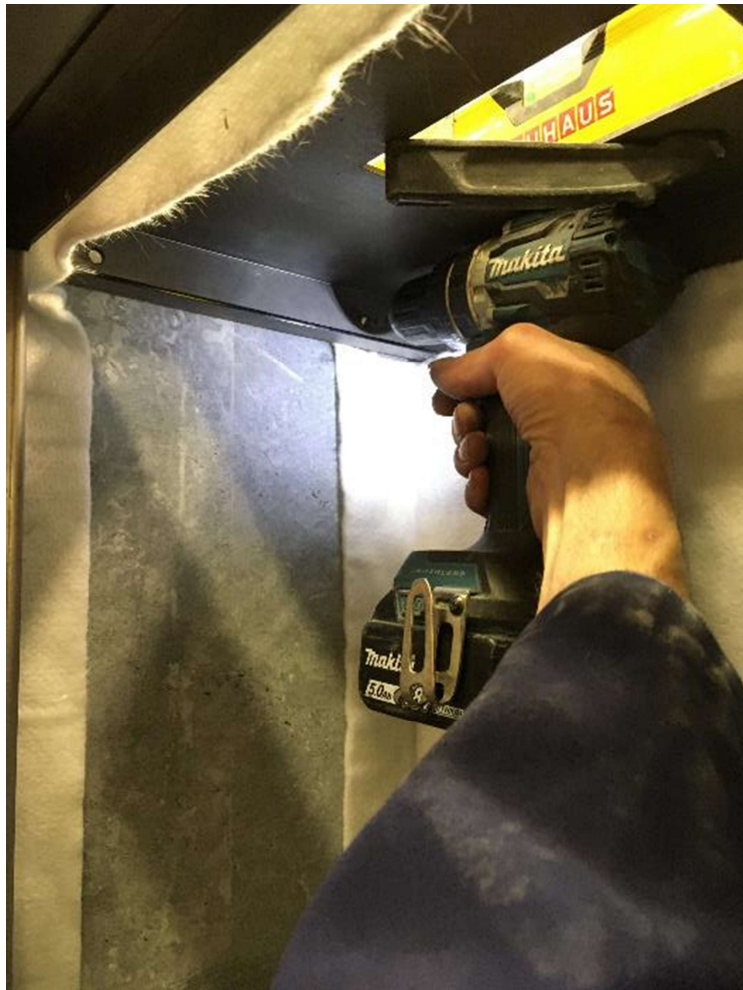

Drill marks to the holes  
Use 4/8 screws (4 extra holes for problems of screws)



< 35 mm

Be careful!!! Do not drill over 35 mm



# Pievu installation



Srews, 4 psc. Do not tighten too much!



Put the cerami paper in top



# Pievu installation



Insulated side of the metal  
Wools: 6 x 27 cm



Insulated side of the metal  
Wools: 6 x 27 cm



# Pievu installation



Install door frame



Tighten from below



# Pievu installation



Tighten the upper srew to the cast iron block



# Pievu installation



Tighten door so, that there approx.1 mm gab



Remember install metal stripes to clip groove





# Pievu installation



Tighten door so, that there approx.1 mm gab

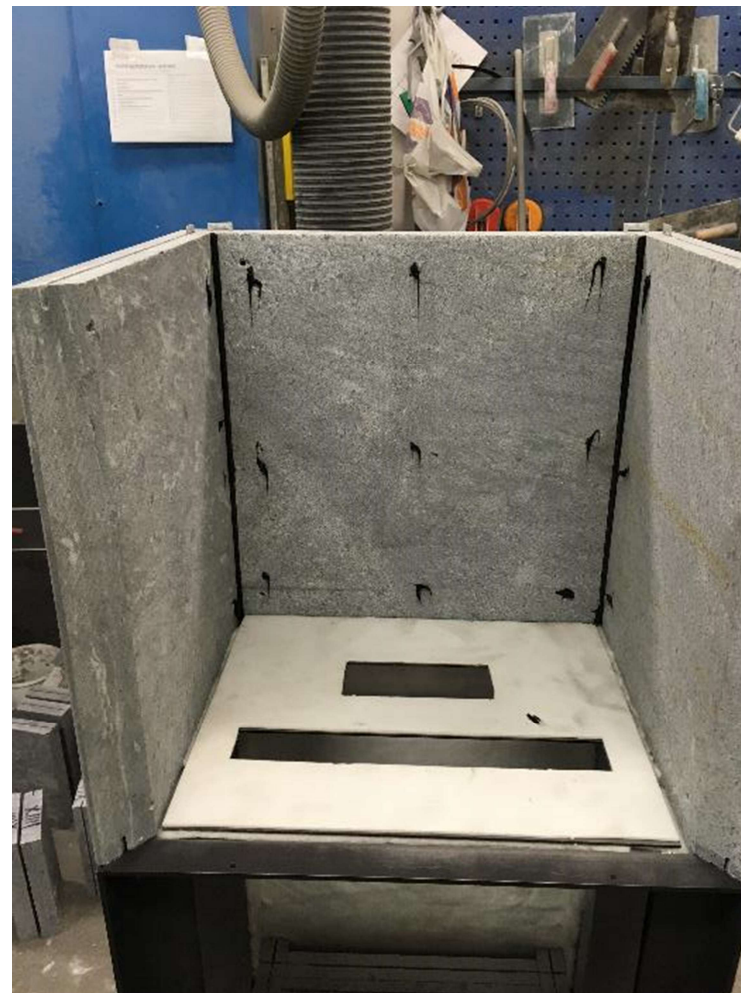

Silicone the corners and dots for wools



# Pievu installation

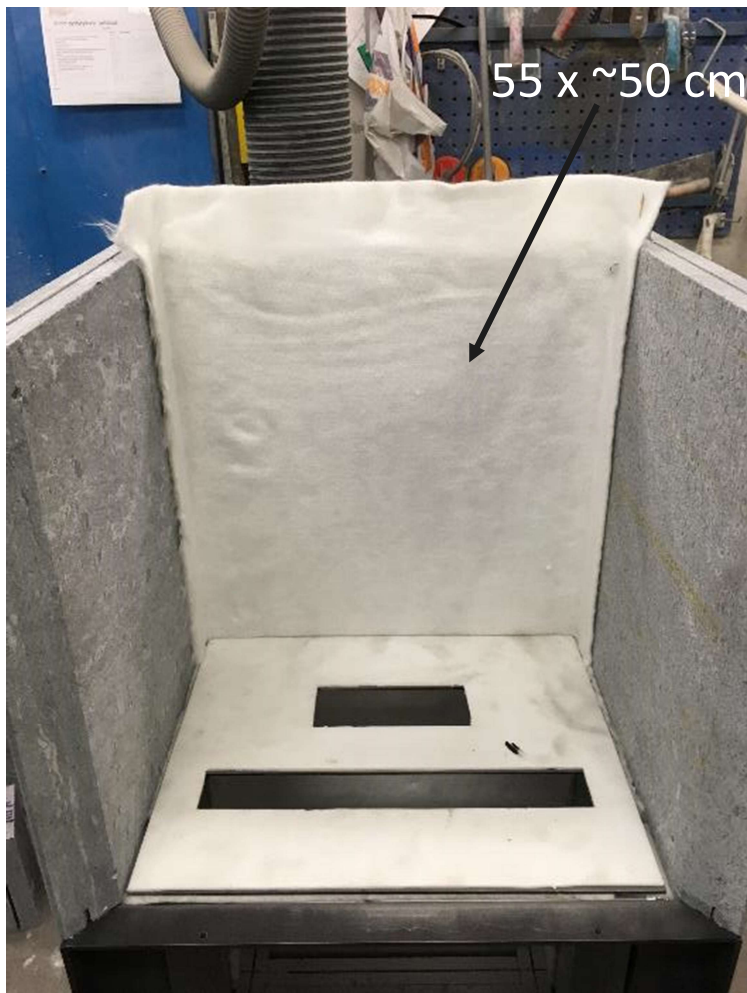

Place 1. wool  
Wools: 55 x 50 cm and 43 x 50 cm

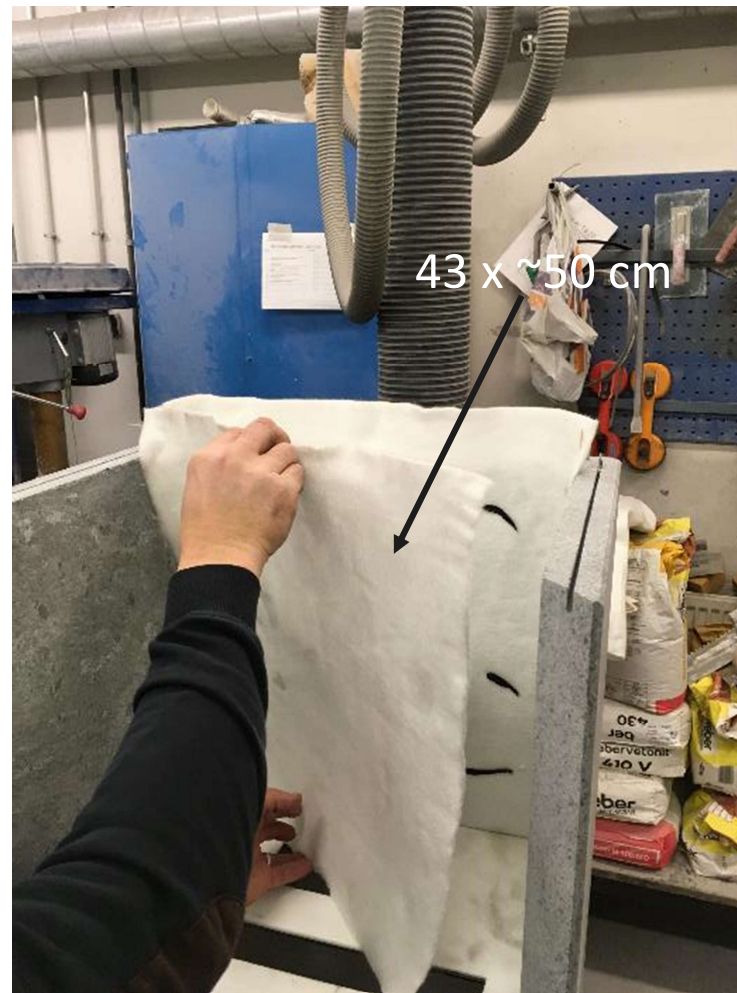

Place 2. wool



# Pievu installation



Wools in sides: 2 x 6 x 38 cm



Install back stone (stone order will be changed)



# Pievu installation



Wools in sides: 2 x 12 x ~45 cm



# Pievu installation



Put metal stripes (45 cm) to the miter corner



Lift the front stone



# Pievu installation



Put silico to the miter corner



Lift the front stone



# Pievu installation

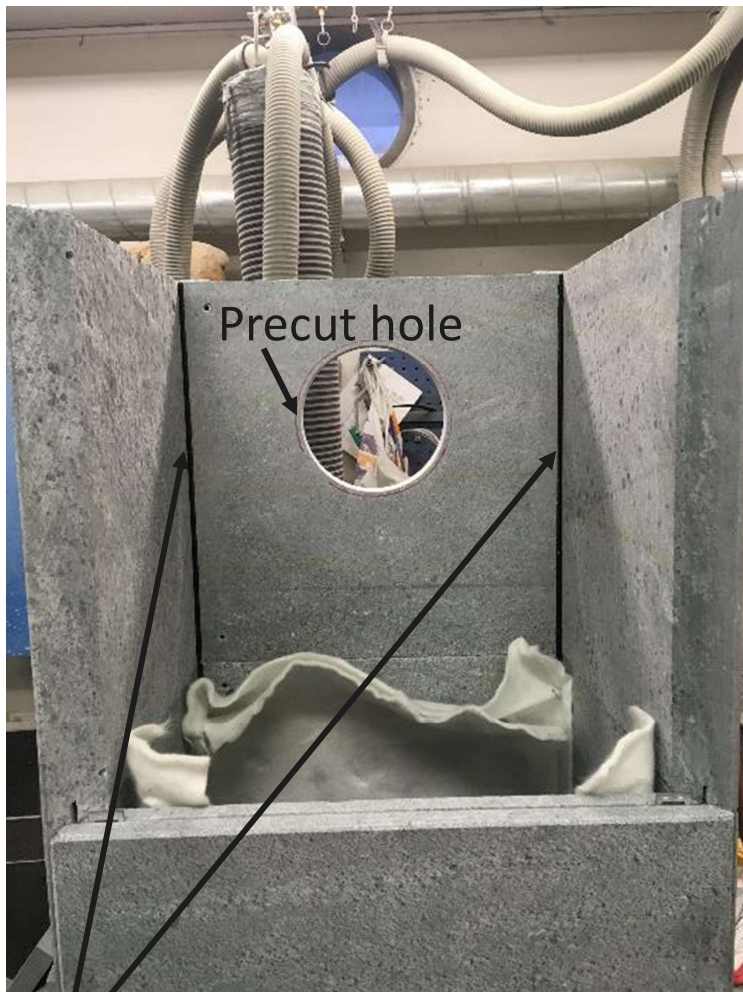

18 version: Install next round stone. Silicone to corners  
If back side chimney: Open precut hole



Lift the front stone



# Pievu installation

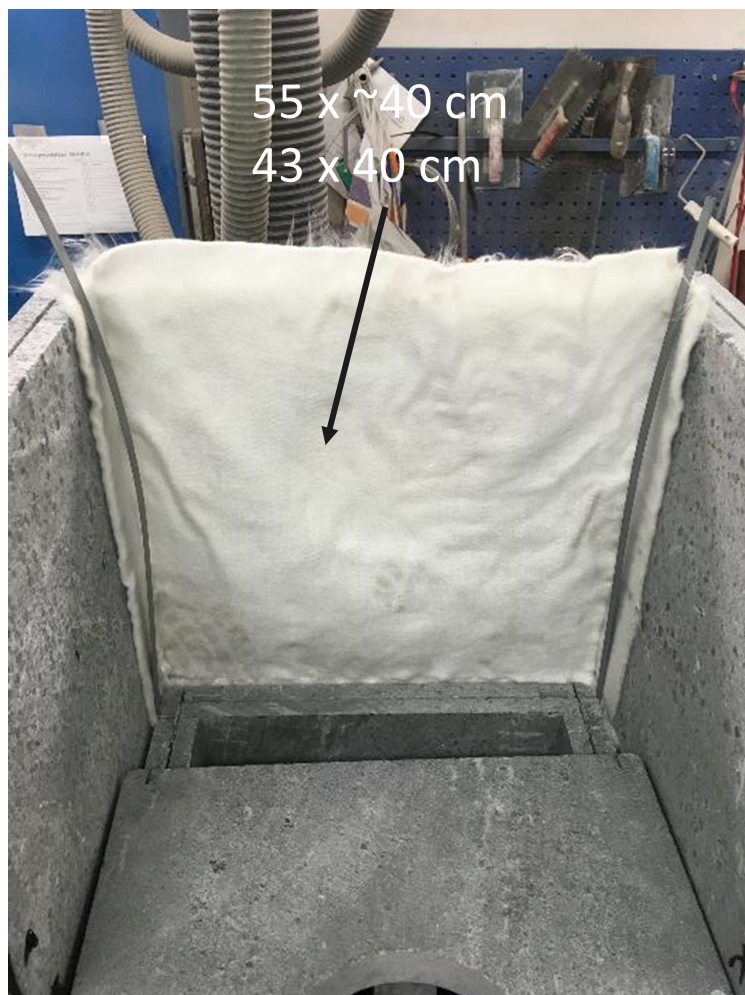

18 version: wools  
55 x 45 cm  
43 x 45 cm

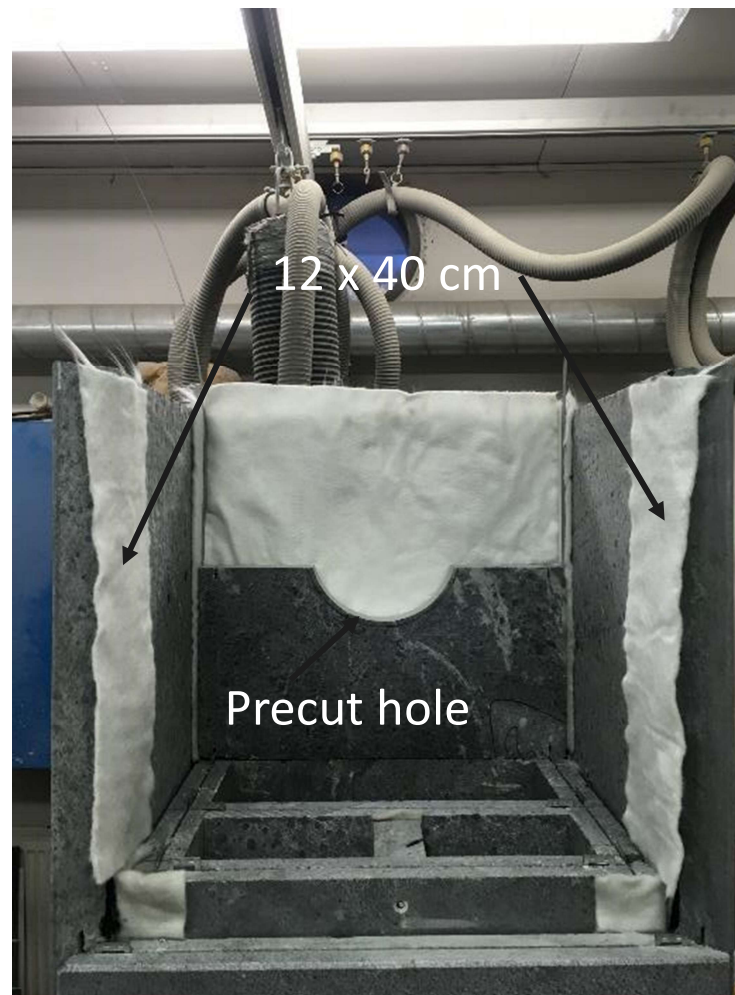

Open precut hole in inside stones,  
if back side chimney  
Wools: 2 x 12 x 40 cm





# Pievu installation



Install inside stone. Open wools back side. Do not cut all wool-> leave wools for insulation

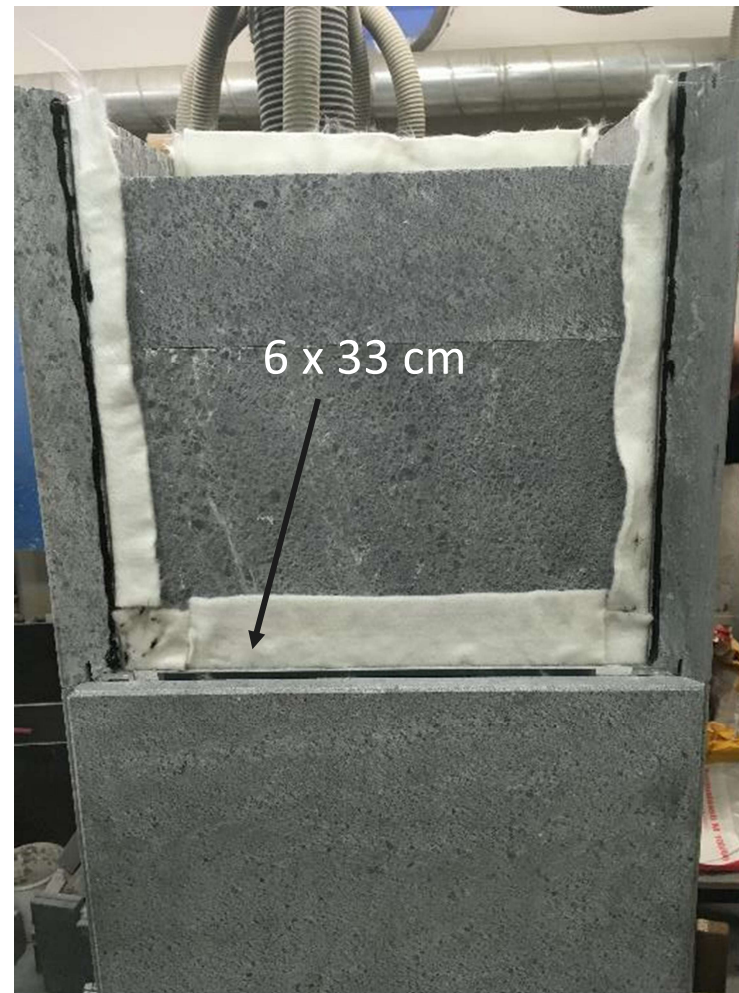

Open precut hole in inside stones, if back side chimney  
Wools: 6 x 33 cm



# Pievu installation

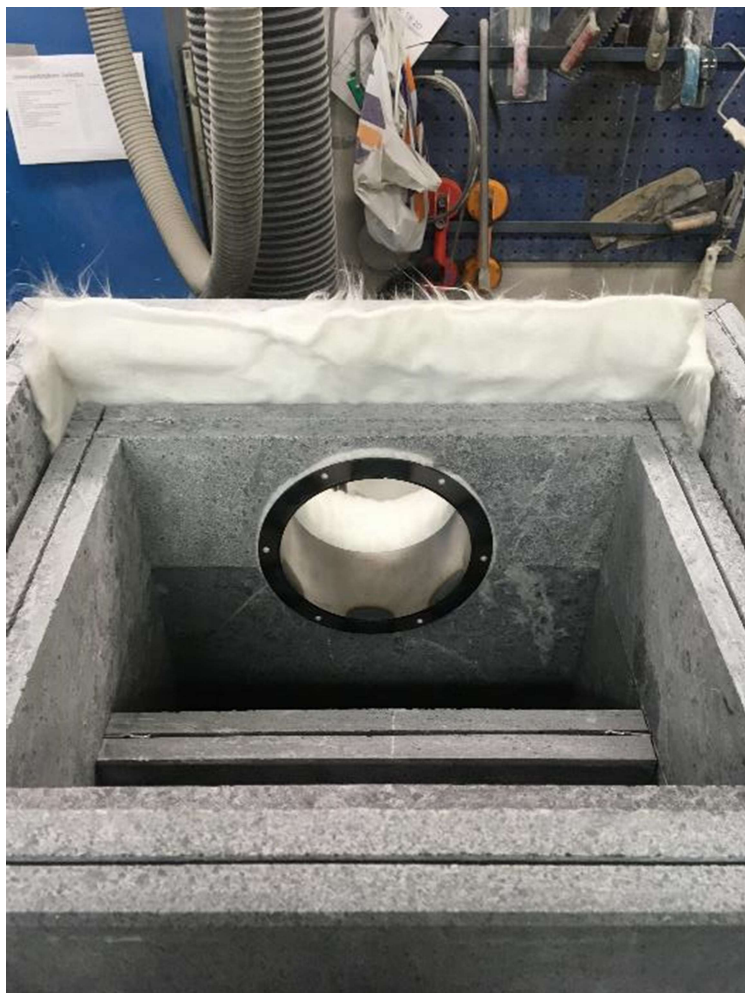

Place chimney connection part

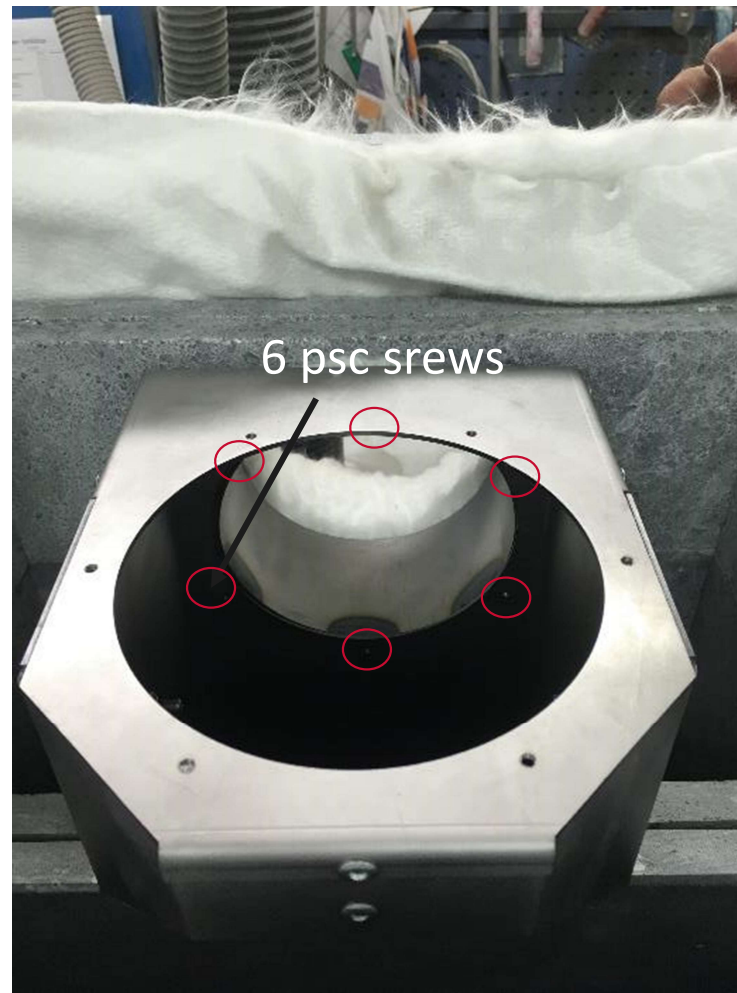

Drop the chimey on its place.  
Srew connection piece



# Chimney connection

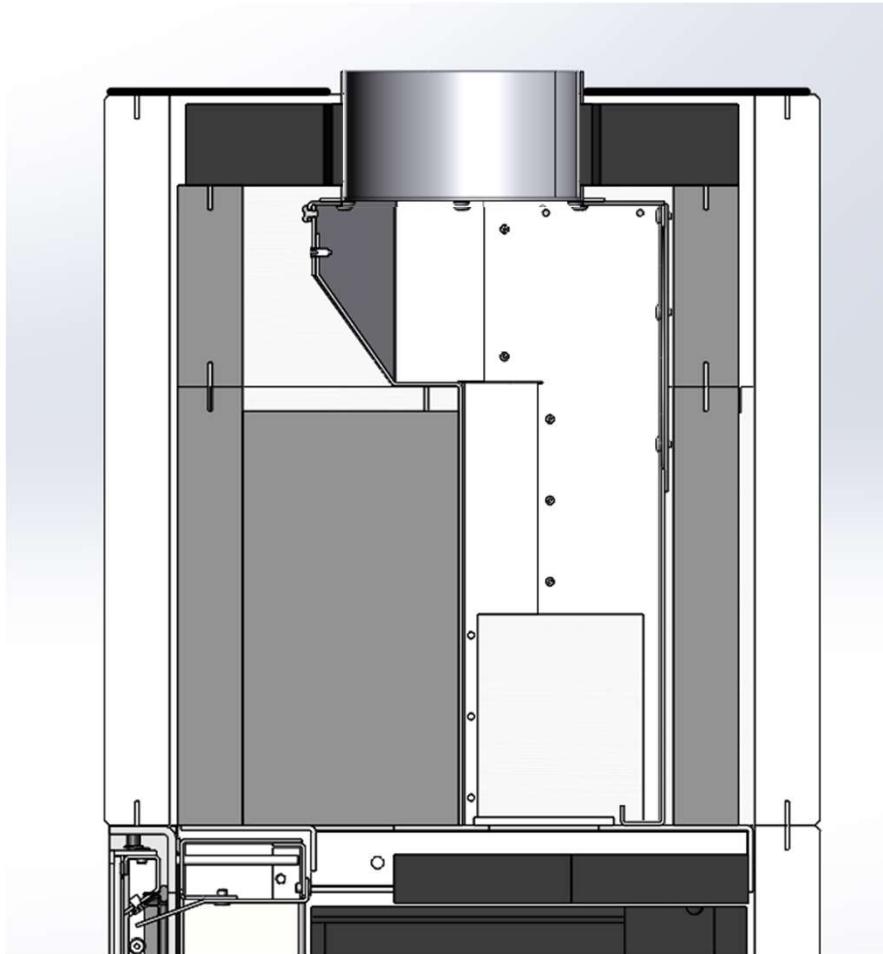

TOP VENT

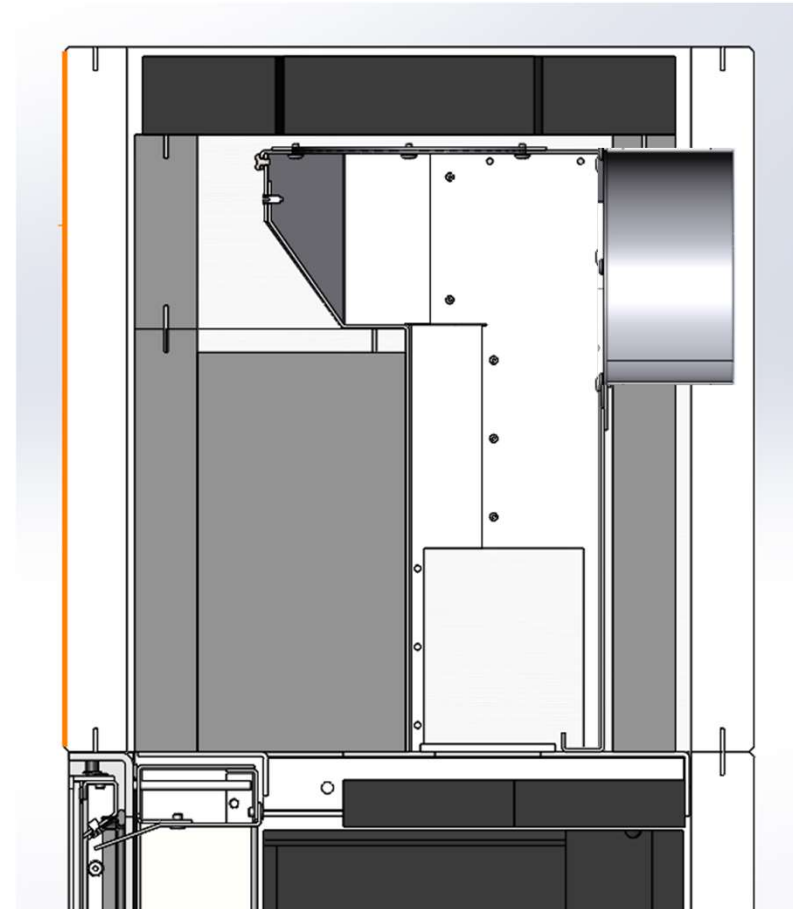

BACK VENT (connection is not over back stone)



# Pievu installation



Back side chimney connection



Install the firebox panels, TOP vermiculate and grate holder, grate and ash box





<sup>®</sup>  
Tulikivi



<sup>®</sup> Tulikivi